

SELM MUIR LMP NGR: NT 088 649

**Map 14. WOODLAND MANAGEMENT IN VISITOR ZONES**

Author: Central Region Planning Team

Scale @ A3: 1:6,000

Date: 06/01/2022

- Legend**
- Selm muir Forest Boundary
  - Rec - Linear Assets
- Visitor Zones**
- Welcome zone - Key arrival or destination point
  - Interactive zone - Buffer around trail
  - Passive zone - Key views / backdrop from trail
- Sustrans National Cycle Network**
- Traffic-free route
  - On-road route
  - Core Paths
  - ScotWays Rights of Way
  - Forest Roads

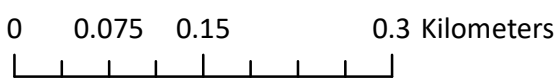

Reproduced by permission of Ordnance Survey on behalf of HMSO.  
 © Crown copyright and database right [2022]. All rights reserved.  
 Ordnance Survey Licence number [100021242].  
 © Getmapping Plc and Bluesky International Limited 2022.

Scotland's National Forest Estate is responsibly managed to the UK Woodland Assurance Standard.

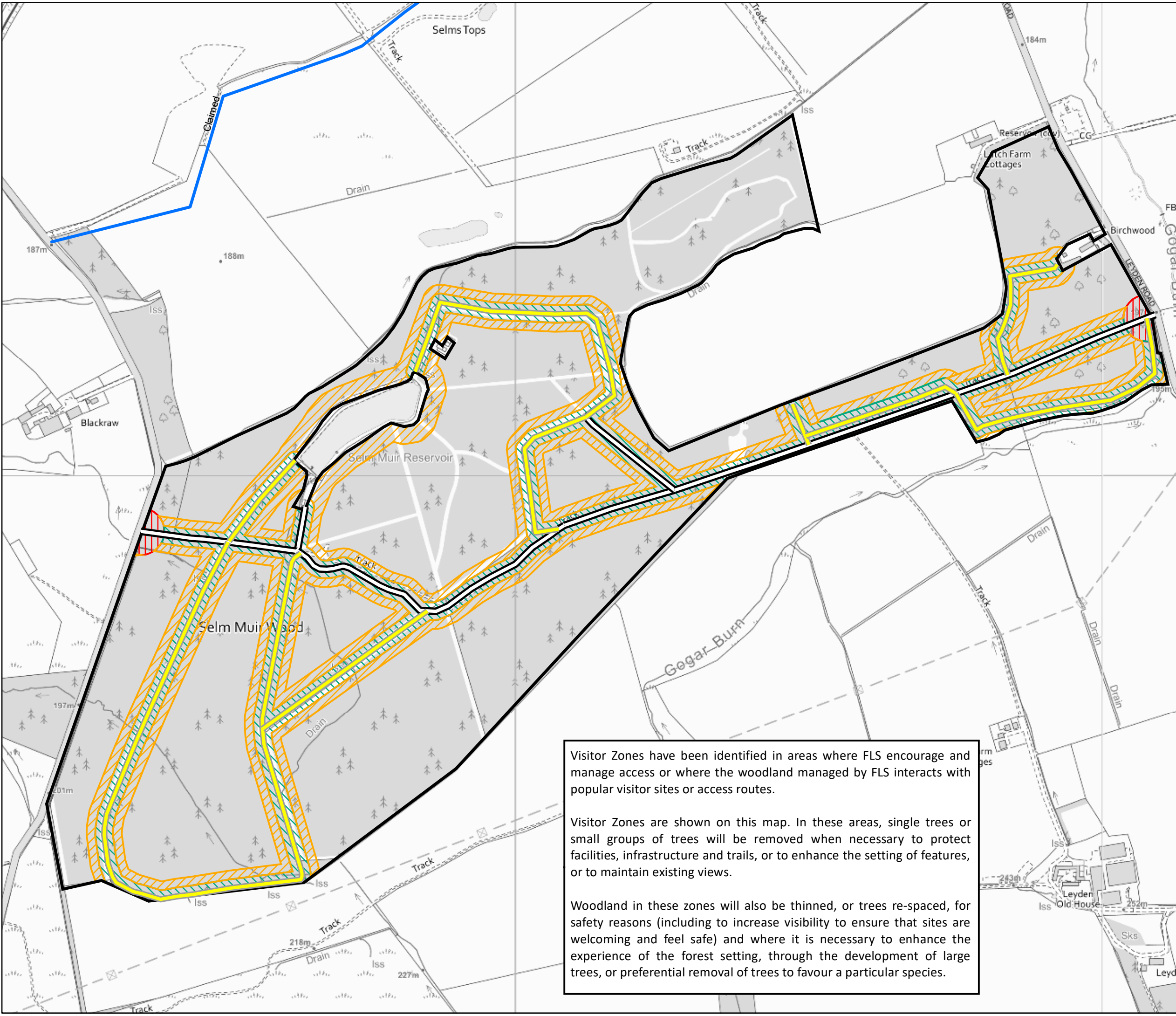

Visitor Zones have been identified in areas where FLS encourage and manage access or where the woodland managed by FLS interacts with popular visitor sites or access routes.

Visitor Zones are shown on this map. In these areas, single trees or small groups of trees will be removed when necessary to protect facilities, infrastructure and trails, or to enhance the setting of features, or to maintain existing views.

Woodland in these zones will also be thinned, or trees re-spaced, for safety reasons (including to increase visibility to ensure that sites are welcoming and feel safe) and where it is necessary to enhance the experience of the forest setting, through the development of large trees, or preferential removal of trees to favour a particular species.