

Piperhill Management & Felling

Author: U321816
 Scale @ A3: 1:10,000
 Date: 12/10/2020

Legend

- Piperhill Boundary
- FLS North Kyle Boundary
- Forest Roads
- Approval Sought**
- Afforestation
- First 5 years
- Restock
- Planned Roads**
- ATV
- Forest Road
- Subs**
- Current Management Coupes**
- Felled
- Phase 1 felling (2021 - 2025)
- Phase 3 felling (2031 - 2035)
- Minimum Intervention
- Water

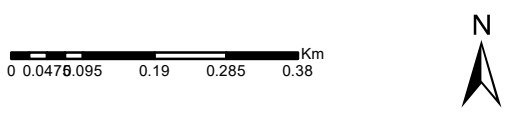

Reproduced by permission of Ordnance Survey on behalf of HMSO.
 © Crown copyright and database right [2020]. All rights reserved.
 Ordnance Survey Licence number [100021242].
 © Getmapping Plc and Bluesky International Limited 2020.

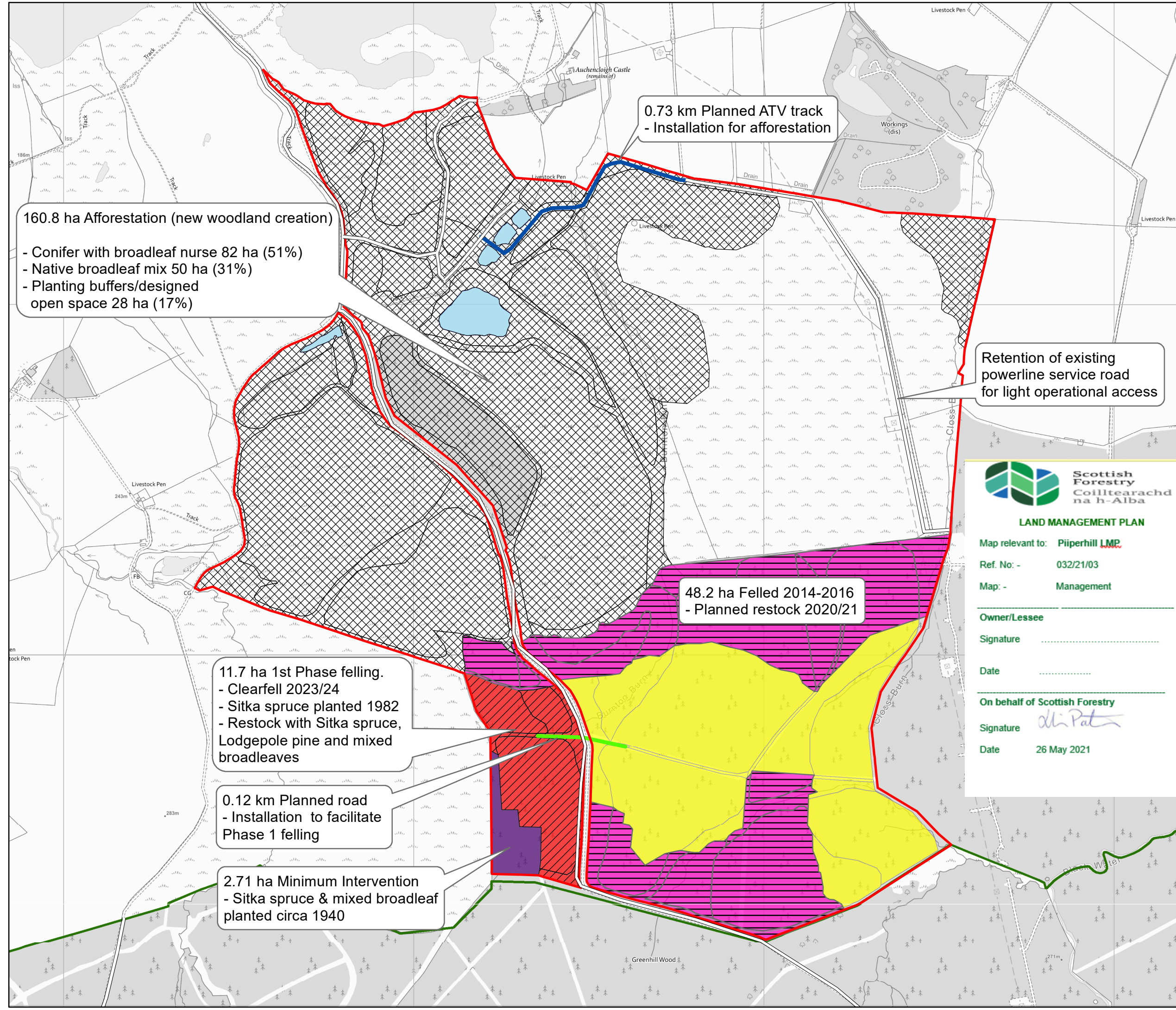

160.8 ha Afforestation (new woodland creation)

- Conifer with broadleaf nurse 82 ha (51%)
- Native broadleaf mix 50 ha (31%)
- Planting buffers/ designed open space 28 ha (17%)

0.73 km Planned ATV track - Installation for afforestation

Retention of existing powerline service road for light operational access

48.2 ha Felled 2014-2016 - Planned restock 2020/21

11.7 ha 1st Phase felling.

- Clearfell 2023/24
- Sitka spruce planted 1982
- Restock with Sitka spruce, Lodgepole pine and mixed broadleaves

0.12 km Planned road - Installation to facilitate Phase 1 felling

2.71 ha Minimum Intervention - Sitka spruce & mixed broadleaf planted circa 1940

LAND MANAGEMENT PLAN

Map relevant to: **Piiperhill LMP**

Ref. No: - 032/21/03

Map: - Management

Owner/Lessee

Signature

Date

On behalf of Scottish Forestry

Signature *Ali Paterson*

Date 26 May 2021